

**01** Sanitize hands.

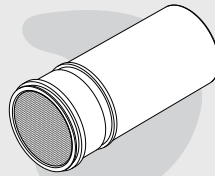

**02** Identify the membrane module.



**03** Inspect the thin black O-ring and slide into the outer crevice of the membrane module.

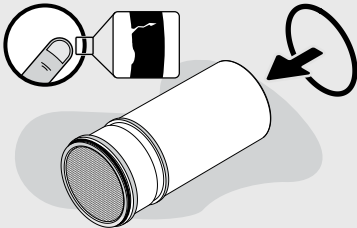

**04** Inspect the thick black O-ring and slide into the middle crevice of the module.

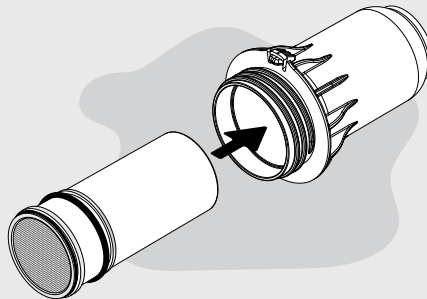

**05** Insert the membrane module into the inflow body.

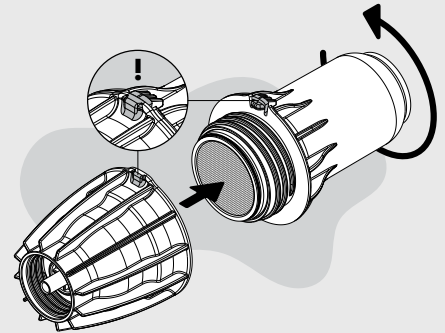

**06** Secure the inflow and outflow body.

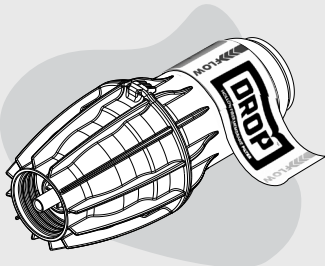

**07** Place the flow sticker on the inflow body.

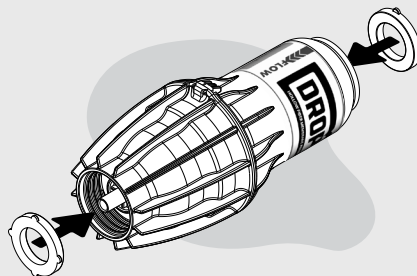

**08** Secure the tabbed washers on the ends of the body.

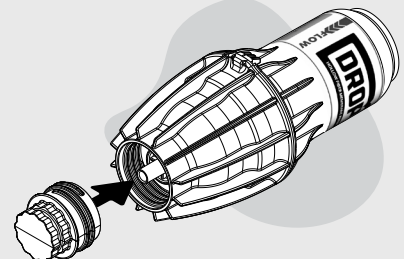

**09** Twist the plug into the outflow body until it is secured.

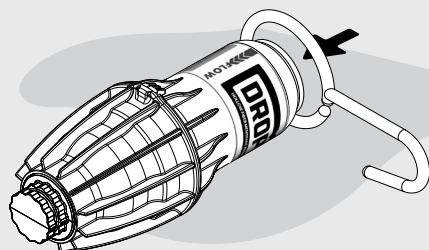

**10** Slide the bucket hook onto the inflow body.

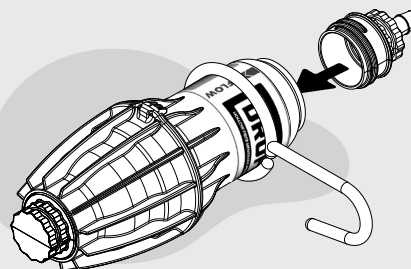

**11** Twist the hose adapter into the inflow housing until it is secured.

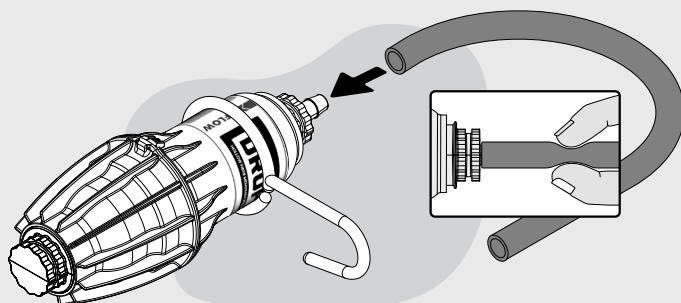

**12** Wiggle the hose onto the adapter.

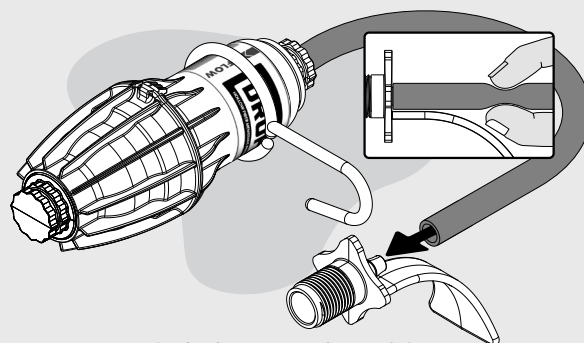

**13** Wiggle the hose onto the nodule for the bucket connector.

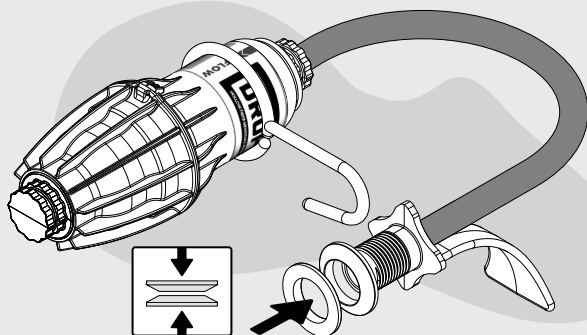

**14** Slide on the beveled washers.

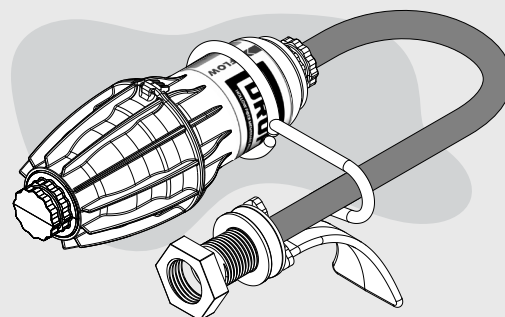

**15** Secure the washers by twisting on the plastic nut. Fold the gray tube and link to the bucket hook.

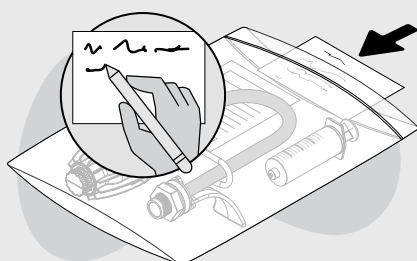

**16** Insert completed filter, cleaning info and tool into the bag.

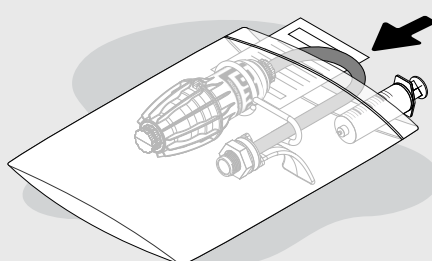

**17** Write and insert your completed field note card and seal the bag.

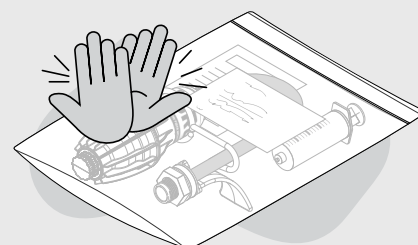

**18** Congratulations, your filter is complete!